

# Art Moderne II

## OG021

### 1000x482

Height: 1000  
 Width: 482  
 Depth: 83  
 Weight HO: kg  
 EO: kg

Tube  $\phi$  : 32 Hex + 25.4  
 Pipe Centres: 450  
 Elec. element if specified: 150  
 Output @ 50° C  $\Delta$  T Watts: 429  
 BTUs: 1464

All dimensions in millimetres

Manufactured from ISO/CEN CuZn36As (BS CZ126) brass tube

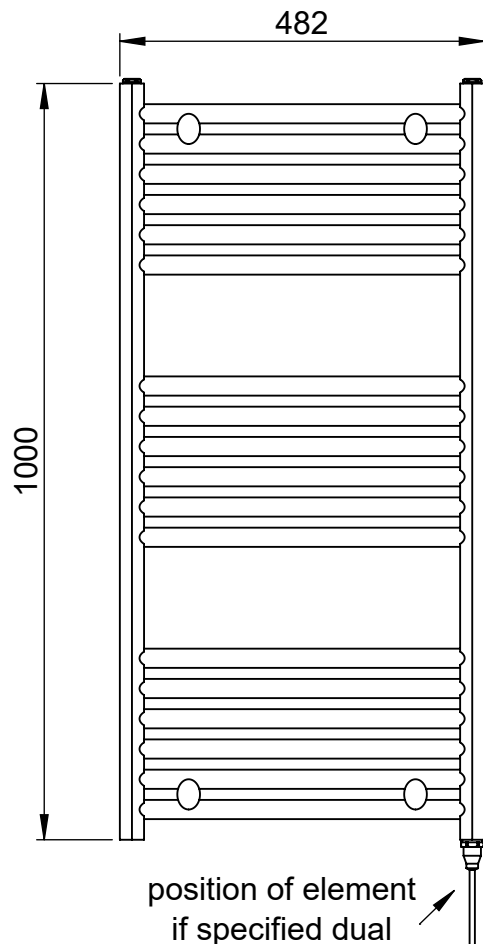
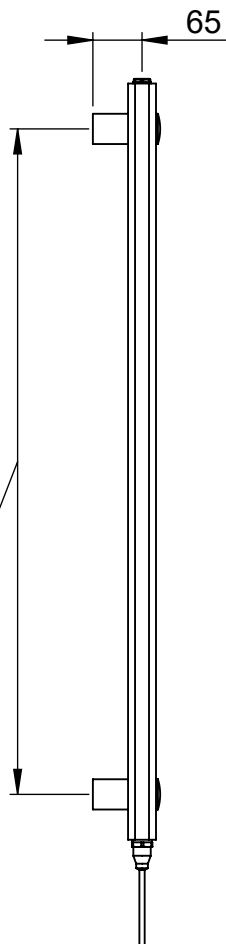
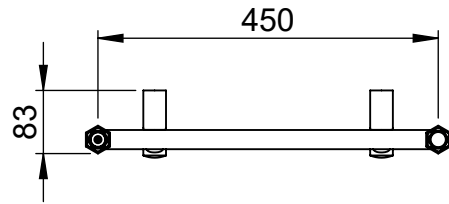
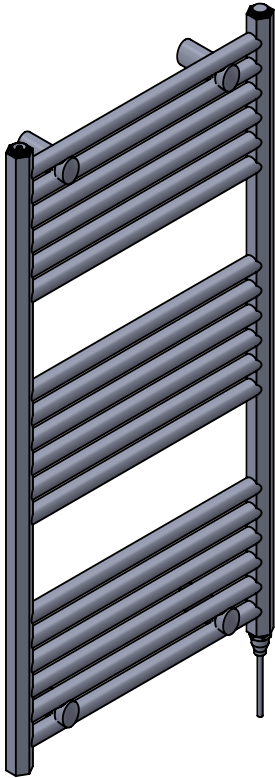

Brackets extendable by a further 20mm

\*Dual energy models require a conversion-tee, consult relevant drawing for details.

Vogue UK Ltd. reserve the right to alter specifications without prior notice.  
 ALL MEASUREMENTS ARE NOMINAL DIMENSIONS ONLY, AND ARE NOT BINDING.

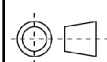

SCALE 1:10



**VOGUE UK**  
 TOWEL WARMERS & RADIATORS

Strawberry Lane, Willenhall  
 West Midlands WV13 3RS  
 Tel: 01902 387000 Fax: 01902 387001  
 e-mail:sales@vogueuk.co.uk www.vogueuk.co.uk